

## **Extracellular Vesicle Core Facility Phase 1 Operation plans**

---

- The laboratory (room 205) and office space (room 204) of the EV Core located in The Rosenthal Building at 3800 Spruce Street will remain private and only accessible to Dr. DeRita and Dean Hoffman. There is adequate space in both the office and lab to maintain physical distancing requirements when applicable.
- The Facility will be offering full service options only, in which samples will be placed on a designated surface by the deliverer near the entrance while maintaining physical distance and required PPE. Once they have exited, only Dr. DeRita will process the samples in the laboratory area (N = 1).
- All equipment and lab surfaces will be disinfected after all necessary research protocols have been performed. This will chiefly be performed with either 70% ethanol and/or Lysol with at least a 10-second contact time on all surfaces.
- Full-service sample processing by the EV Core will be offered at a 20% discounted rate.
- All other Core-related work that may be done remotely when laboratory procedures are completed will be performed remotely.
- All meetings and consultations will be performed remotely via phone or other online meeting platform of choice. Likewise, communications to coordinate contact-free sample drop offs will be coordinated via email or phone.

Email: [rmderita@upenn.edu](mailto:rmderita@upenn.edu)

Phone: 267-575-0161

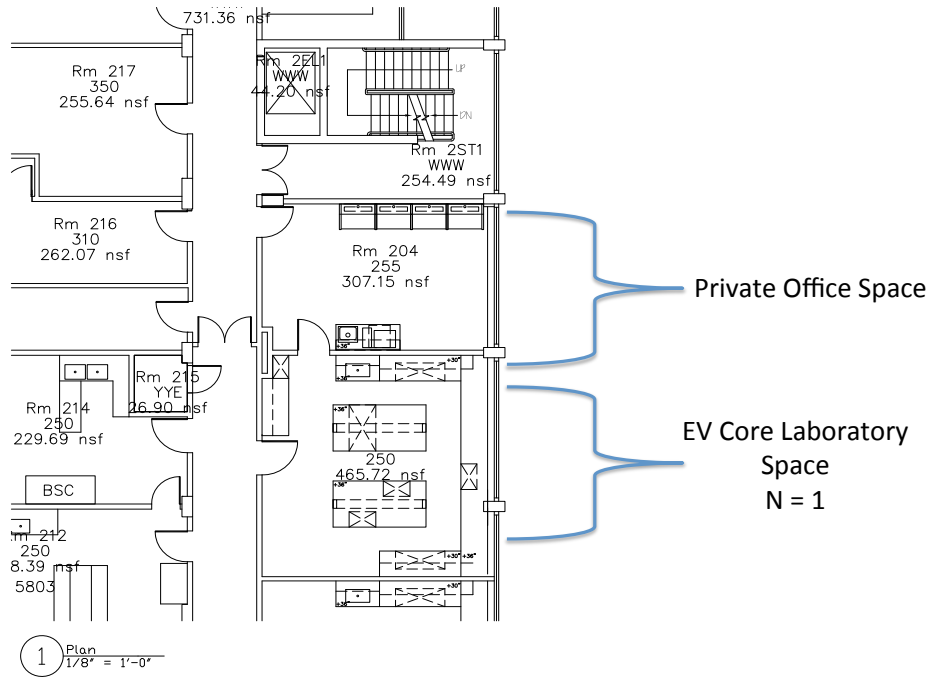

Research Restart  
University of Pennsylvania  
School of Veterinary Medicine  
Rosenthal Second Floor  
5/22/2020  
1/8" = 1'-0"